

*Soundings

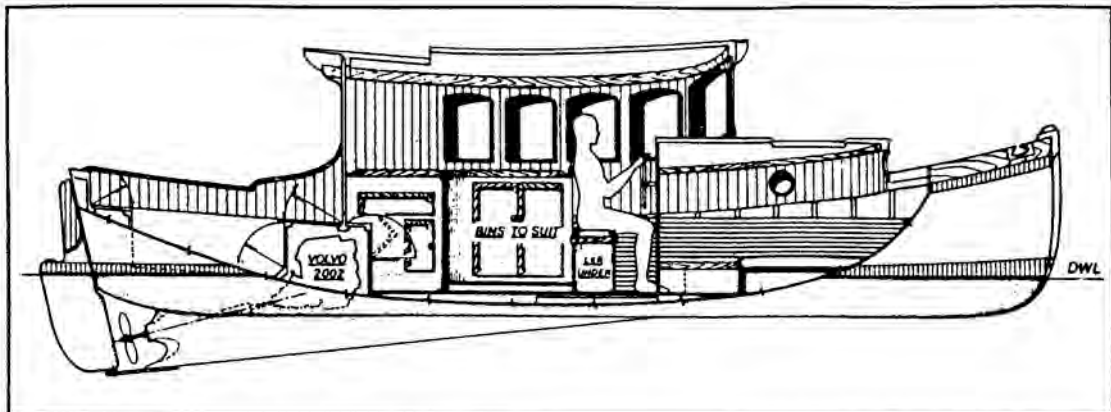

Escapade captures the spirit of Gay Nineties launches. It has roomy accommodations for a cruising couple and is available as a motorsailer.

Gerr's escapade: Recapturing a proven cruising tradition

Have you ever wanted an antique boat because you love the look and the way they ease through the water? Have you ever wished that someone would make a new one so you wouldn't have to restore or maintain a genuine antique?

If you answered "yes" to both questions, you may be interested in the latest collaboration between designer Dave Gerr and builder Howie Mittleman of North River Boatworks. The duo has produced the Escapade motor cruiser and the Egressus motorsailer, both of which are based on the same hull and built of wood.

The hull in question is a modified Whitehall type. Whitehalls were working rowboats developed in Manhattan and built at Whitehall Street. Harbor pilots, ships chandlers, newspaper reporters and insurance adjusters are among the people who regularly used Whitehalls.

Gerr's modified Whitehall form has a narrow beam, sharp entry and fine run aft, a shape that should give an easy motion. Escapade will cruise at 7.5 to 8 knots on a few pints of fuel per hour and has a range of 300 nautical miles on its 40-gallon diesel tankage. Gerr estimates the fuel expense at 80 cents an hour.

Power for both boats is an 18-hp Volvo 2002 diesel twin, turning a 16-inch prop through a 2.4:1 reduction gear.

Escapade and Egressus are 25 feet long overall, have a waterline length of 24.33 feet and a beam of 7.33 feet. Escapade draws 2.5 feet, and Egressus, because of its

deeper full-length keel, draws 2 feet 9 inches. The motor yacht displaces 4,200 pounds, and the motorsailer about 1,000 pounds more in the form of lead housed in the keel.

Kudos to Gerr for designing a small boat as a small boat. Accommodations appear to be comfortable for a cruising couple who occasionally invite guests aboard for a day outing or dinner. If the weather's nice, overnight guests can sleep in the cockpit, but Gerr has provided real sleeping quarters for two in a huge vee berth forward. The wheelhouse/main salon is 10 feet long and has 6 feet of head room. It also contains the head, galley and settee. The head has a shower and stand-up head room. The cockpit is 6.5 feet long and can be equipped with an outside helm.

The motorsailer's 255-square-foot rig is technically a ketch — the mizzen steps forward of the rudder post — but it functions more as a yawl. Most of the drive comes from the low-aspect-ratio main and jib. The fully batten jigger balances the helm, helps tack the long-keel hull and keeps the boat head to wind when it's at anchor. The main mast step is a tabernacle and can be easily lowered for passing under bridges.

Construction is cedar strip planking and epoxy resin sheathed with polyester and fiberglass cloth, also set in epoxy. North River in addition to completed boats offers bare hull for finishing at home. Gerr also offers complete plans.

Dave Gerr — Gerr Marine, Inc.
838 West End Ave. — Suite BB
New York, NY 10025 USA
Tel: 212-864-7030
Fax: 212-932-0872